

护脚墙典型断面

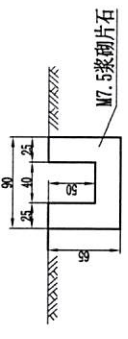

排水边沟断面



片石排水沟断面

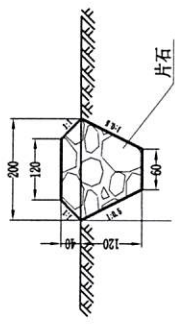

截水沟断面

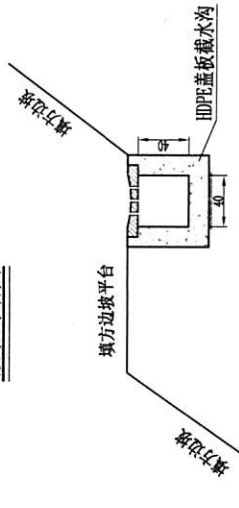

片石排水沟平面示意图

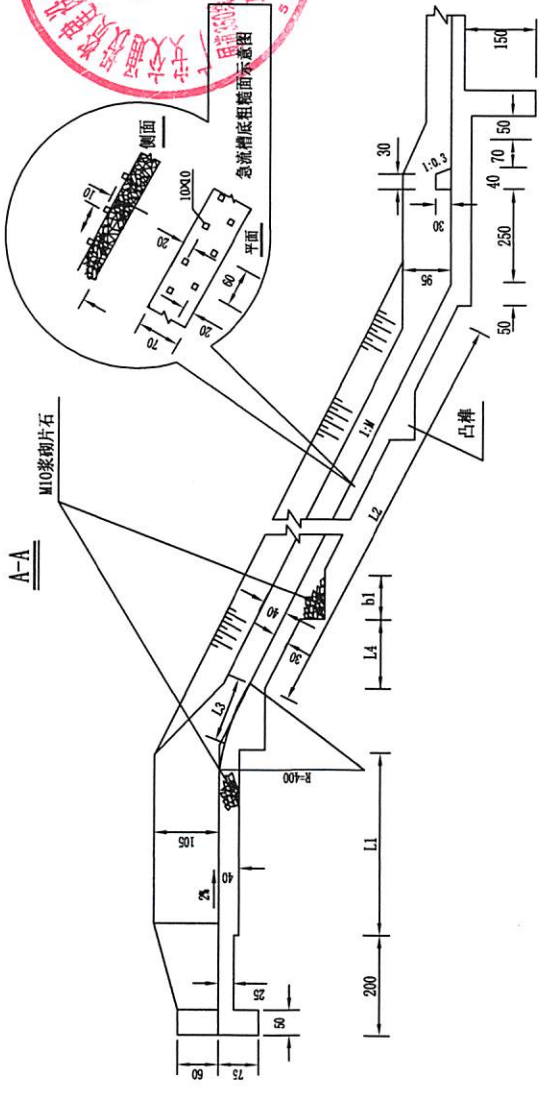

片石排水沟纵断面示意图

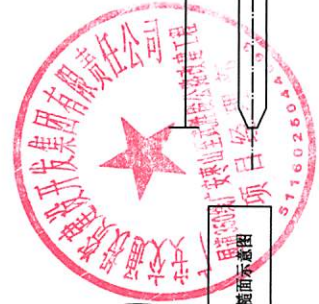
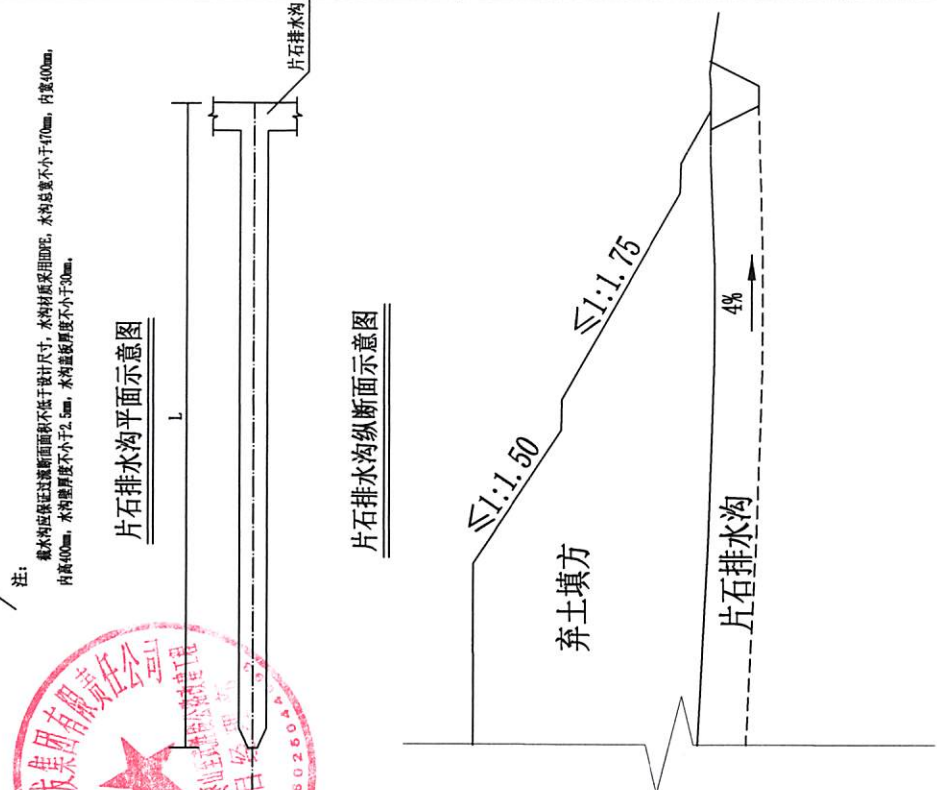

平面图

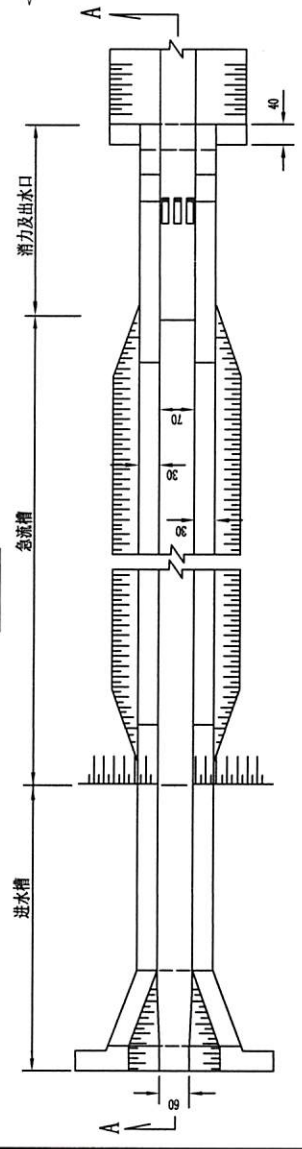

注：
截水沟应保证过流断面面积不小于设计尺寸，水和材料采用HDPPE，水沟总宽不小于470mm，内宽400mm，内高400mm，水沟壁厚不小于2.5mm，水沟盖板厚度不小于30mm。

